

## Parts included with the CS6000i sewing machine

Please ensure that all are accounted for before returning this item to the library.

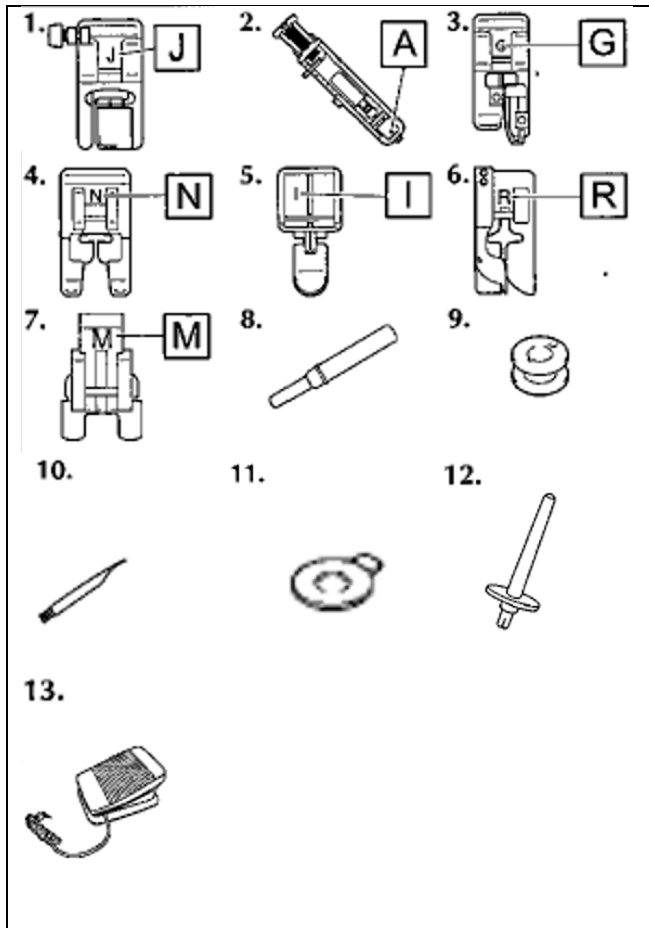

No.	Part Name	Replacement Cost
1	Zigzag foot - J	\$10
2	Buttonhole foot - A	\$10
3	Overcasting foot - G	\$10
4	Monogramming foot - N	\$10
5	Zipper foot - I	\$10
6	Blind stitch foot – R	\$10
7	Button fitting foot – M	\$10
8	Seam ripper	\$2
9	Bobbin (4)	\$1 each
10	Cleaning brush	\$2
11	Disc-shaped screwdriver	\$2
12	Extra spool pin	\$1
13	Foot controller	\$20
	Power cord	\$12
	Needles (4 in bag, 1 on machine)	\$1 each
	Manual	\$5
	Rolling case	\$90
	Brother CS6000i sewing machine with hard cover	\$180